

FLOOR PLANS & CAPACITY CHART

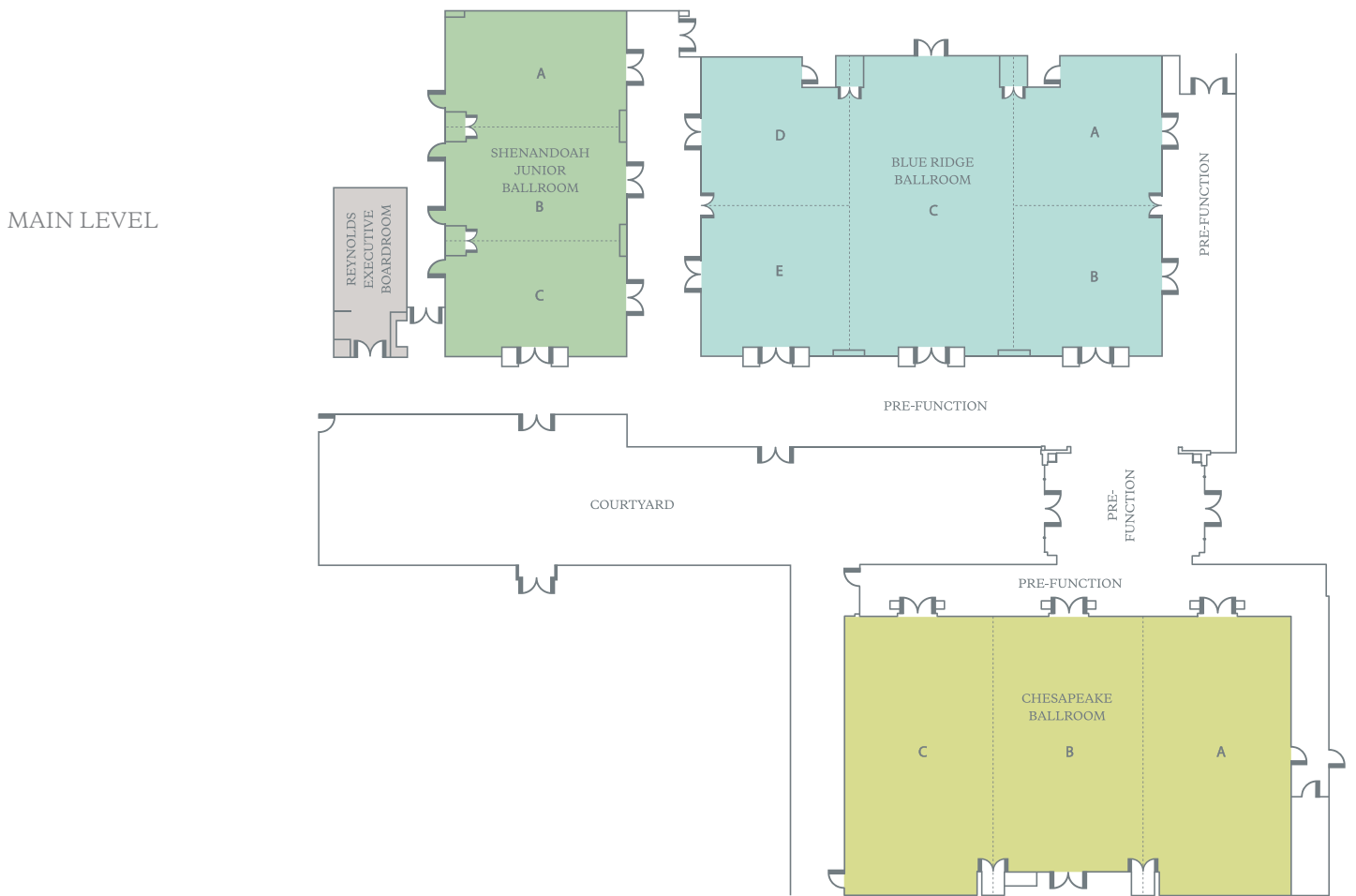

ROOM NAME	DIMENSIONS	TOTAL SQ. FEET	CEILING	BANQUET	THEATER	CONFERENCE	RECEPTION	CLASSROOM	U-SHAPE
Blue Ridge Ballroom - Total	56' x 84'	4,387	15' - 10"	300	550	78	500	280	70
Salon A	27' x 27'	683	15' - 10"	50	80	15	65	35	20
Salon B	27' x 27'	712	15' - 10"	50	80	15	65	35	20
Salon AB	54' x 27'	1,395	15' - 10"	100	165	40	120	80	45
Salon C	56' x 30'	1,595	15' - 10"	120	200	40	180	110	50
Salon ABC	54' x 57'	2,990	15' - 10"	250	320	50	300	200	60
Salon D	27' x 27'	684	15' - 10"	50	80	15	65	35	20
Salon E	27' x 27'	713	15' - 10"	50	80	15	65	35	20
Salon DE	54' x 27'	1,397	15' - 10"	100	150	40	120	80	45
Salon CDE	54' x 57'	2,992	15' - 10"	250	420	50	300	200	60
Shenandoah Jr. Ballroom - Total	62' x 33'	1,989	17' - 0"	150	230	55	160	130	60
Salon A	21' x 32'	664	17' - 0"	50	70	20	50	30	18
Salon B	20' x 33'	668	17' - 0"	50	70	20	50	30	18
Salon C	21' x 32'	656	17' - 0"	50	70	20	50	30	18
Salon AB	41' x 33'	1,332	17' - 0"	100	120	30	100	60	35
Salon BC	41' x 33'	1,324	17' - 0"	100	120	30	100	60	35
Reynolds Executive Boardroom	30' x 13'	390	10' - 0"	--	--	12	--	--	--
Pre-function	104' x 16' x 49' x 10' & 44' x 10'	3,420	17' - 0"	--	--	--	250	--	--
Chesapeake Ballroom - Total	56' x 90'	4,769	13' - 8"	350	625	100	550	325	100
Salon A	56' x 30'	1,625	13' - 8"	130	200	50	200	125	45
Salon B	51' x 30'	1,519	13' - 8"	100	150	35	150	90	35
Salon C	56' x 30'	1,625	13' - 8"	130	200	50	200	125	45
Salon AB	56' x 60'	3,143	13' - 8"	270	350	85	350	215	70
Salon BC	56' x 60'	3,143	13' - 8"	270	350	85	350	215	70
Chesapeake Pre-function	93' x 9' & 40' x 27'	1,956	13' - 8"	--	--	--	200	--	--
Courtyard	130' x 45'	5,850	--	--	--	--	300	--	--